

ADDENDUM NO. 1
November 3, 2020

PART 1 - GENERAL

1.1 PROJECT

- A. Brooks Stadium East Gates, H17-N123-MJ
Coastal Carolina University, Conway, SC

1.2 ARCHITECT

- A. SMHa, Inc.
400 Hibben Street, Suite 100 Mt. Pleasant, SC 29464
(843) 881-7642

1.3 RELATED DOCUMENTS

- A. This Addendum consists of 4 addendum pages, plus 4 revised drawing sheets.
- B. To Prime Bidders of Record:

- 1.4 This addendum forms a part of the Contract Documents and modifies the original Project Manual and Drawings dated October 12, 2020. Acknowledge receipt of this addendum on the Bid Form. Failure to do so may cause a bid to be rejected as unresponsive as outlined in the Instructions to Bidders.

PART 2 - ADDENDUM ITEMS

2.1 PRE-BID CONFERENCE

- A. Pre-Bid Conference:
 - 1. The Pre-Bid Conference was held on October 27, 2020 at 11:00 a.m. at Coastal Carolina University, Outside at Gate 3, Brooks Stadium, Conway, South Carolina. Attendance at the conference was not mandatory.

2. The following representatives of the Agency, the Office of the State Engineer, and the Architect were in attendance:

Margaret Jordan	OSE	803-737-0773	MJordan@mmo.sc.gov
Mark Avant	CCU	843-349-2152	avant@coastal.edu
Billy Connell	SMHa	843-881-7642	b.connell@smha.com
Sam Herin	SMHa	843-881-7642	s.herin@smha.com

3. The following is a list of attendees at the Pre-Bid conference. This is not intended to restrict the bidders on this project. Bidding on this project is open to all qualified bidder whether or not they attended the Pre-Bid.

Chris Setter	Mashburn Construction	csetter@mashburnconstruction.com
James Hutton	JMEC Construction 843-382-7576	jim@jmecco.com
Rob Edwards	Maritime Builders 843-796-1817	rdedwards@trustmaritime.com
Kent Gunter	FBi Construction 843-665-0408	kgunter@fbiconstruction.com
Jacob Smith	Rhino Demolition	jmsmith@rhinodemolition.com
Michael Allen	Allen's Demolition	michael@allensdemo.com
Roger Crib	HR Allen	(?) jamie.pass@hrallen.com
Mark Howard	Conway Fence	conwayfence@sccoast.net
James DiSabato	Mancill Inc.	jamesd@mancill.net
Jimmy Cumming	Mancill Inc.	jimmiec@mancill.net
Dave Gomer	Peachtree Electrical	dave.gomer@peachtree.electrical.com
Bill Sanford	Macsons Demo	bsanford@macsons.com
Debbie Jenkins	Tyson Sign Co. 843-455-6447	djenkins@tysonsign.com
Don Daniels	Electric Service	don@escarolinas.com

2.2 GENERAL REQUIREMENTS:

A. OSE AIA Document A101 – 2017 Exhibit A.

1. §A.3.3 Property Insurance. Delete this section in its entirety.

B. SUMMARY 011000

1. Paragraph 1.4 ACCESS TO SITE.
 - a. Add paragraph B. “Contractor shall secure the stadium openings created by the Work during and between Work activities and at off hours. Provide a suitable temporary construction fence of similar height of existing fence, at each opening, in accordance with OSE AIA201 §10.2 Safety of Persons and Property.”
 - b. Add paragraph C. “The Owner shall coordinate with the Contractor a designated laydown area and parking plan in the vicinity of the Work.”

2.3 ARCHITECTURAL

A. Sheet A000. Replace sheet with revised sheet A000 with 10/28/2020 revision date. A summary of revisions is as follows:

1. Added Gate Numbers for clarification
2. Added Construction Note 1, temporary fencing requirements.

B. Sheet A101. Replace sheet with revised sheet A101 with 10/28/2020 revision date. A summary of revisions is as follows:

1. Clarified Gate Numbers on details.
2. Clarified extent of pavement and gate demolition.
3. Clarified extent of new concrete slab, control joints, and expansion joints.
4. Clarified logo requirements on gates and added detail.
5. Added signage and lettering requirements for each gate.
6. Deleted requirement for galvanizing steel fabrication.

C. Sheet A102. Replace sheet with revised sheet A102 with 10/28/2020 revision date. A summary of revisions is as follows:

1. Clarified Gate Numbers on details.
2. Clarified extent of wire mesh on all gate trusses.
3. Changed letter size on all gate signage to 16” for each gate.
4. Deleted requirement for galvanizing steel fabrication.

D. Sheet A103. Replace sheet with revised sheet A103 with 10/28/2020 revision date. A summary of revisions is as follows:

1. Section 055000. Metal Fabrications.
 - a. Paragraph 2. Deleted words “Stainless Steel.” Standard expanded metal mesh to match existing.
 - b. Added Paragraph 5 requiring shop priming of fabricated steel.
2. Section 099100. Painting. Deleted section and replaced in its entirety with the following changes.
 - a. Paragraph 1. Added General Section clarifying paint basis of design and MPI numbers.
 - b. Paragraph 2. Deleted words “Galvanized Metal” and subparagraph referencing preparation of galvanized steel. Steel shall be ungalvanized and shop primed.
 - c. Paragraph 2. Delete entire paragraph.
3. Section 101400. Signage. Added section in its entirety to clarify technical requirements.
4. Section 323000. Fencing. Clarified logo requirements consistent with detail added on Sheet A101.

2.4 STRUCTURAL

- A. Sheet S102. Views 6, 7, and 8. Clarification. Expanded metal mesh shall be provided on one side (signage side) of each truss only. Refer only to revised architectural drawings for extent.

2.5 ELECTRICAL

- A. No addenda items.

END OF ADDENDUM NO. 1

DRAWINGS MAY NOT BE REPRODUCED WITHOUT PERMISSION

ALL RIGHTS RESERVED

MEMBERS AMERICAN INSTITUTE OF ARCHITECTS

400 HIBBEN STREET, MOUNT PLEASANT, SOUTH CAROLINA

SMHa, Inc.

COPYRIGHT 2019

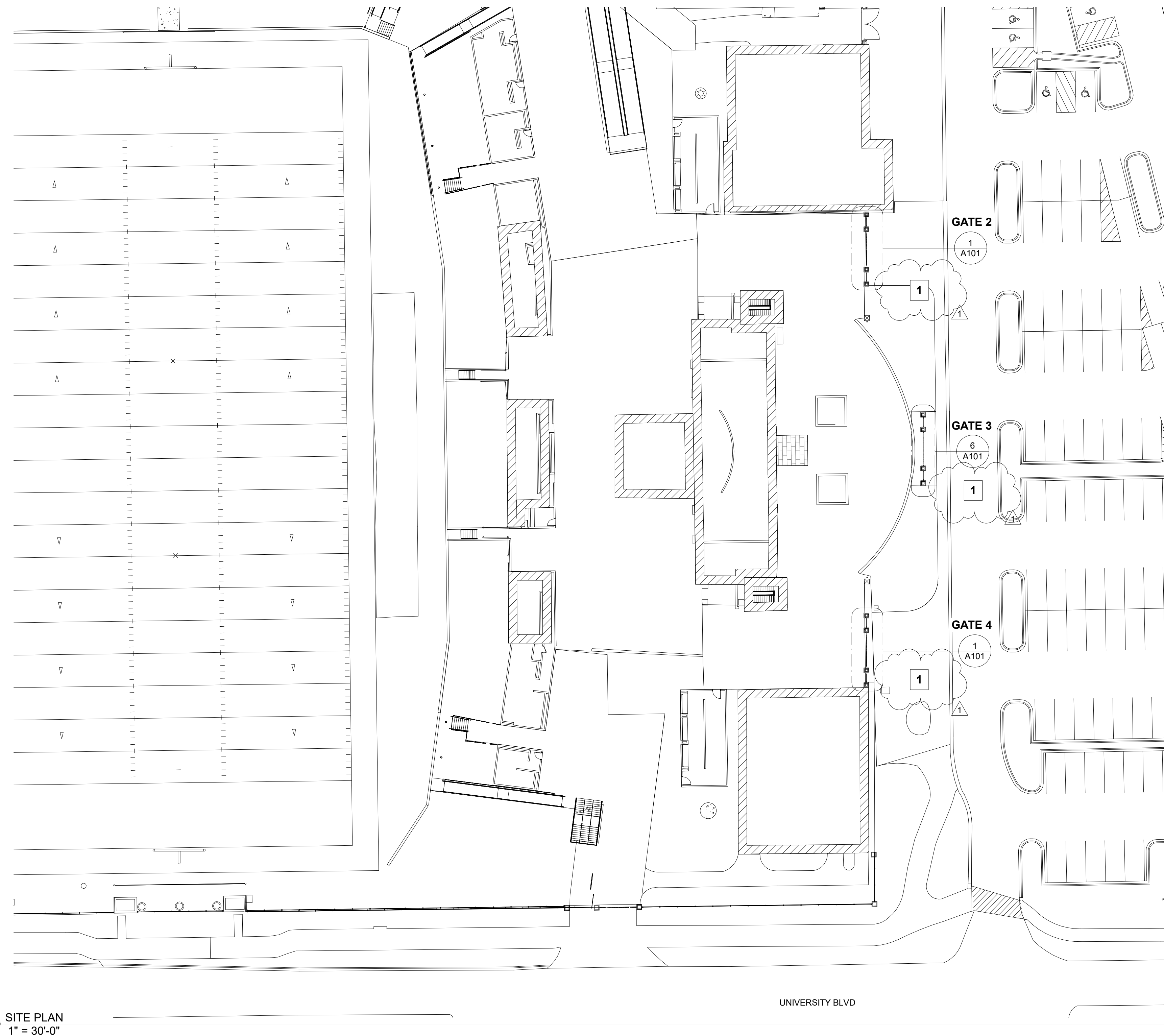

PROJECT INFORMATION

architect
 SMHa, INC.
 400 Hibben St.
 Mount Pleasant, SC 29464
 SAM HERIN
 843.881.7642
 s.herin@smha.com

structural
 MARTINEZ & ASSOCIATES
 STRUCTURAL ENGINEERS, PA
 1107 48th Avenue North . 310C
 Myrtle Beach, SC 29577
 SAUL J. MARTINEZ
 843.839.1620
 saulm@sccoast.net

mep
 DWG, INC.
 1009 Anna Knapp Blvd., Suite 202
 Mount Pleasant, SC 29464
 WILL BILLARD
 843.849.1141
 wbillard@dwginc.com

Project Address
 540 University Blvd., Suite 202
 Conway, SC 29526
 TMS#: 150-00-07-152
 Current Owner: Coastal Carolina University

DRAWING INDEX

Issue Date	Sheet No.	Sheet Title
01 GENERAL		
04.01.19	A000	COVER SHEET
02 STRUCTURAL		
02.27.19	S101	VIEWS 1-4
02.27.19	S102	VIEWS 5-8
02.27.19	S103	VIEWS 9-12
02.27.19	S104	VIEWS 13-15
02.27.19	S105	CONSTRUCTION NOTES
03 ARCHITECTURAL		
04.01.19	A101	PLANS, ELEVATIONS AND DETAILS
04.01.19	A102	DETAILS
04.01.19	A103	SPECS
04 ELECTRICAL		
02.20.20	E101	ELECTRICAL SITE PLAN

THE FOLLOWING DRAWING ARE FOR INFORMATION ONLY AND ARE FROM BROOKS STADIUM PHASE 2, #17-9610-MJ. REFERENCE CODE IS 2015 IBC PER OSE.

09.20.17	LS101	OSE CODE REVIEW INFORMATION
02.20.20	LS102	LIFE SAFETY PLAN - LEVEL 1

CONSTRUCTION NOTES

(APPLY TO THIS SHEET ONLY)

- 1 PROVIDE 6' TALL CHAIN LINK CONSTRUCTION FENCING AT EACH GATE AS REQUIRED TO SECURE ACCESS TO STADIUM AND PROTECT AREA OF WORK.

rev no.	description	date
1	ADDEMDUM 01	11.03.20

CONSTRUCTION DOCUMENTS

date of issue: 02.20.20

SMHa project no: 1905.00

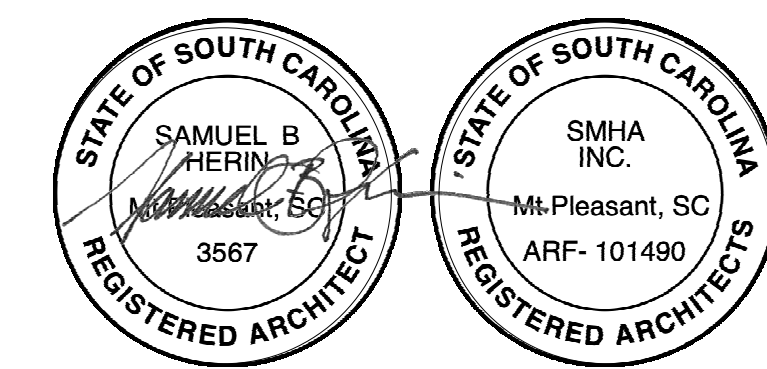

architecture • planning • interiors

CCU BROOKS STADIUM EAST GATES CONWAY, SC

STATE PROJECT NO. H17-N123-MJ

GENERAL NOTES:

- A. DIMENSIONS TO FACE OF MASONRY UNLESS NOTED OTHERWISE.
- B. ALL EXTERIOR MASONRY DIMENSIONS ARE NOMINAL. FOR ACTUAL DIMENSIONS SEE ENLARGED DETAILS. CONTRACTOR SHALL MAKE PROPER ALLOWANCES FOR JOINT DIMENSIONS WHEN LAYING OUT THE WORK.
- C. GENERAL CONTRACTOR TO LAYOUT LOCATION OF PIERS ACCORDING TO THE DIMENSIONS SHOWN ON THIS SHEET RELATIVE TO THE EXISTING PIERS.
- D. PATCH AND REPAIR ALL EXISTING CONSTRUCTION WHERE DEMOLITION OR ADJOINING OR INTERSECTING WORK RESULTED IN LESS THAN A FINISHED CONDITION. PATCHES SHALL BE FLUSH AND SMOOTH AND OF THE SAME MATERIAL AS EXISTING CONSTRUCTION.
- E. EXISTING WORK THAT ARE NOT INDICATED TO BE AFFECTED BY THE WORK ARE TO BE PROTECTED FROM DAMAGE. SHOULD THE GENERAL CONTRACTOR AFFECT THE CONDITION OR FINISH OF EXISTING WORK, THE SURFACE OR SPACE SHALL BE RESTORED TO ORIGINAL CONDITION.
- F. THE ELEVATION OF THE NEW PIERS SHALL MATCH THAT OF THE EXISTING PIERS.
- G. NOTIFY THE ARCHITECT OF ANY AND ALL DISCREPANCIES BETWEEN EXISTING CONDITIONS AND THE CONTRACT DOCUMENTS BEFORE PROCEEDING WITH THAT PORTION OF THE WORK. FAILURE TO NOTIFY THE ARCHITECT WILL NOT RELIEVE THE CONTRACTOR OF THE RESPONSIBILITY TO PERFORM THE WORK AS INTENDED BY THE CONTRACT DOCUMENTS.
- H. VERIFY EXISTING DIMENSIONS, CONDITIONS AND CLEARANCES PRIOR TO THE SUBMISSION OF SHOP DRAWINGS.

CONSTRUCTION NOTES.

(APPLY TO THIS SHEET ONLY)

- 1. NEW FENCE/GATE CONSTRUCTION TO MATCH EXISTING. PROVIDE ALL HARDWARE AND ACCESSORIES FOR COMPLETE INSTALLATION, MATCH EXISTING TYP. FOR ALL NEW GATES.
- 2. GATE LOGO TO BE SOLID MTL. PLAQUE WITH ATHLETIC DEPARTMENT CHANTICLER LOGO ATTACHED - BOTH SIDES OF FENCE. THIS PHOTO IS FOR REFERENCE OF STYLE ONLY. CONTRACTOR TO SUBMIT PROOF FOR OWNER/ARCHITECT APPROVAL.
- 3. INTERNALLY ILLUMINATED 16" CHANNEL LETTERS "BOOK ANTIQUA" FOTN.
- 4. 6" REINFORCED CONCRETE SLAB W/ 6X6XW2.9XW2.9 2" FROM BOTTOM SLAB.

DEMOLITION NOTES

(APPLY TO THIS SHEET ONLY)

- 1. REMOVE ALL EXISTING FENCING AND GATES BETWEEN EXISTING PIERS.
- 2. GATE POSTS AT EXISTING PIERS MAY REMAIN AND BE REUSED AT CONTRACTORS OPTION. REPAINT TO MATCH NEW WORK.
- 3. CUT AND REMOVE EXISTING CONCRETE SLAB BETWEEN WITH EXISTING CONTROL JOINTS AND BRICK PAVERS. REPLACE WITH NEW SLAB.

ABBREVIATIONS

- B.O. BOTTOM OF
- C.I.P. CAST IN PLACE
- C.T. CONTROL JOINT
- DIA. DIAMETER
- GALV. GALVANIZED
- T.O. TOP OF
- J.T. JOINT
- F.V. FIELD VERIFY

LEGEND:

- EXISTING CONSTRUCTION TO REMAIN
- DEMOLITION TAG
- NEW CONSTRUCTION TAG



8 LOGO REFERENCE
1/2" = 1'-0"

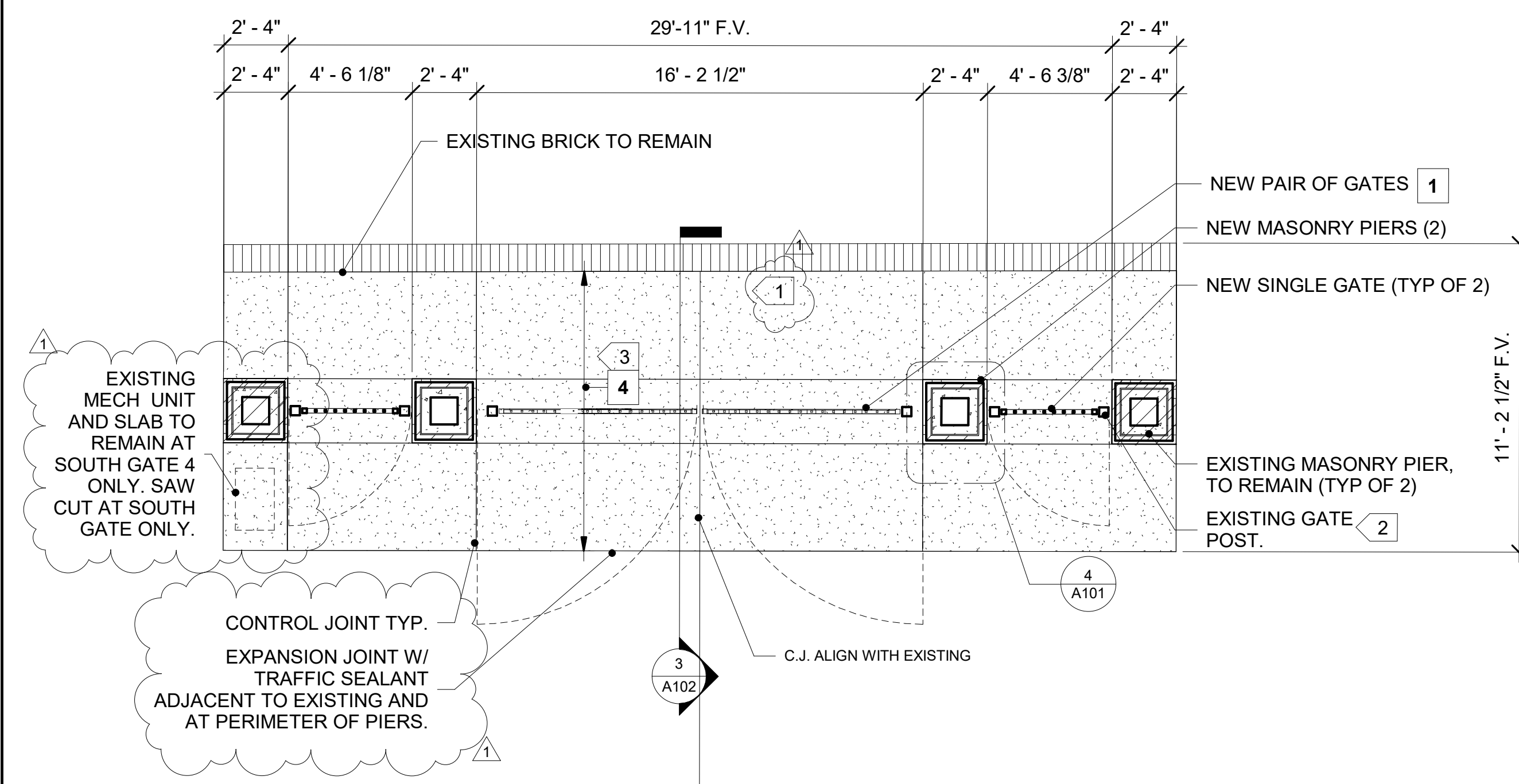

1 SOUTH GATE 4 AND NORTH GATE 2
1/4" = 1'-0"

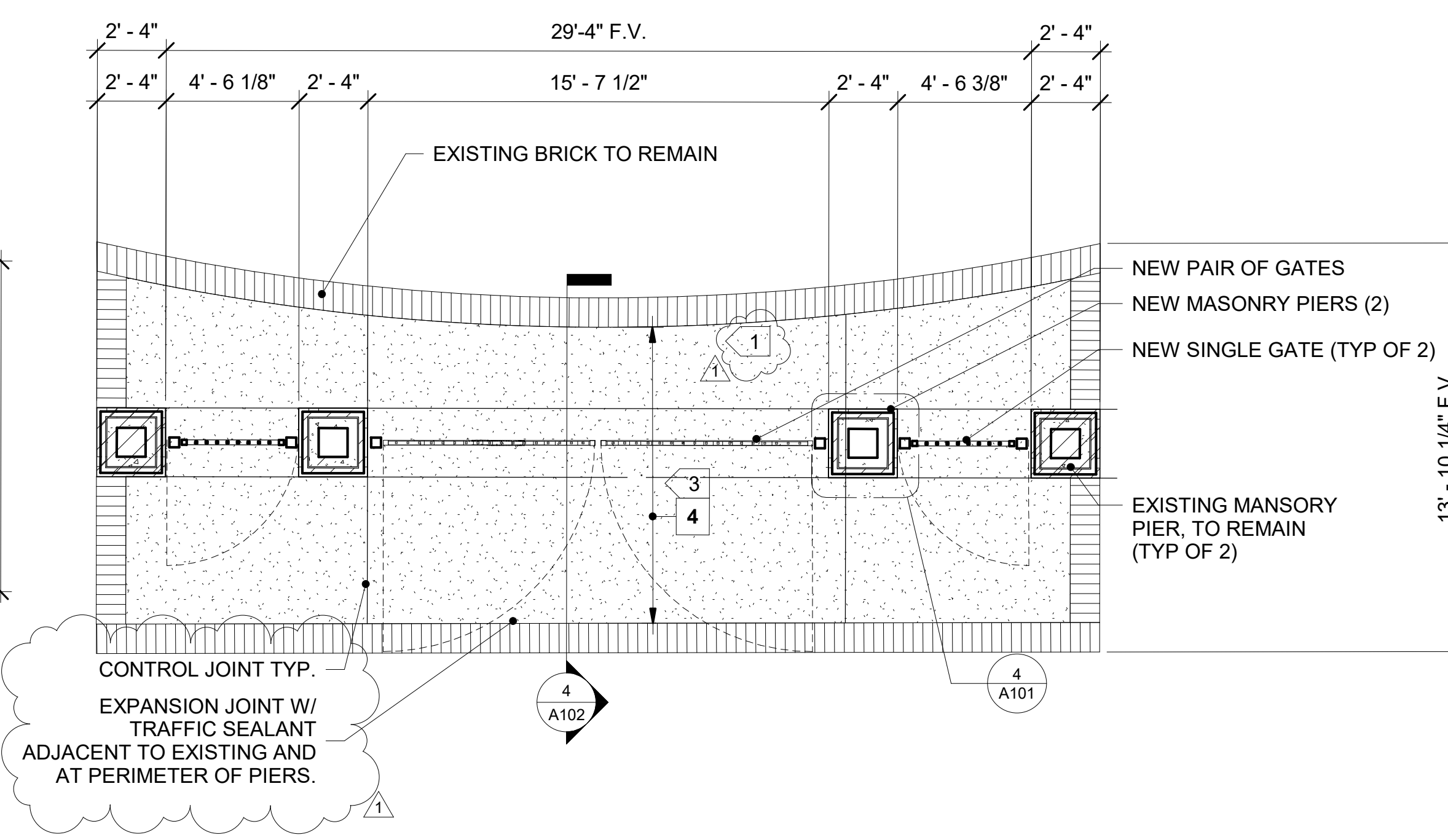

6 CENTER GATE 3
1/4" = 1'-0"

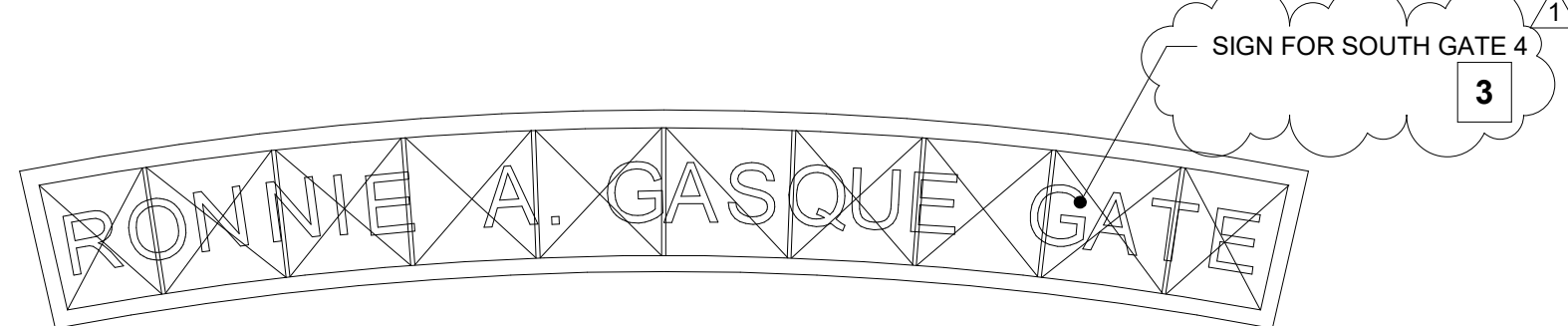

9 SOUTH GATE 4 ELEVATION SIGN
1/4" = 1'-0"

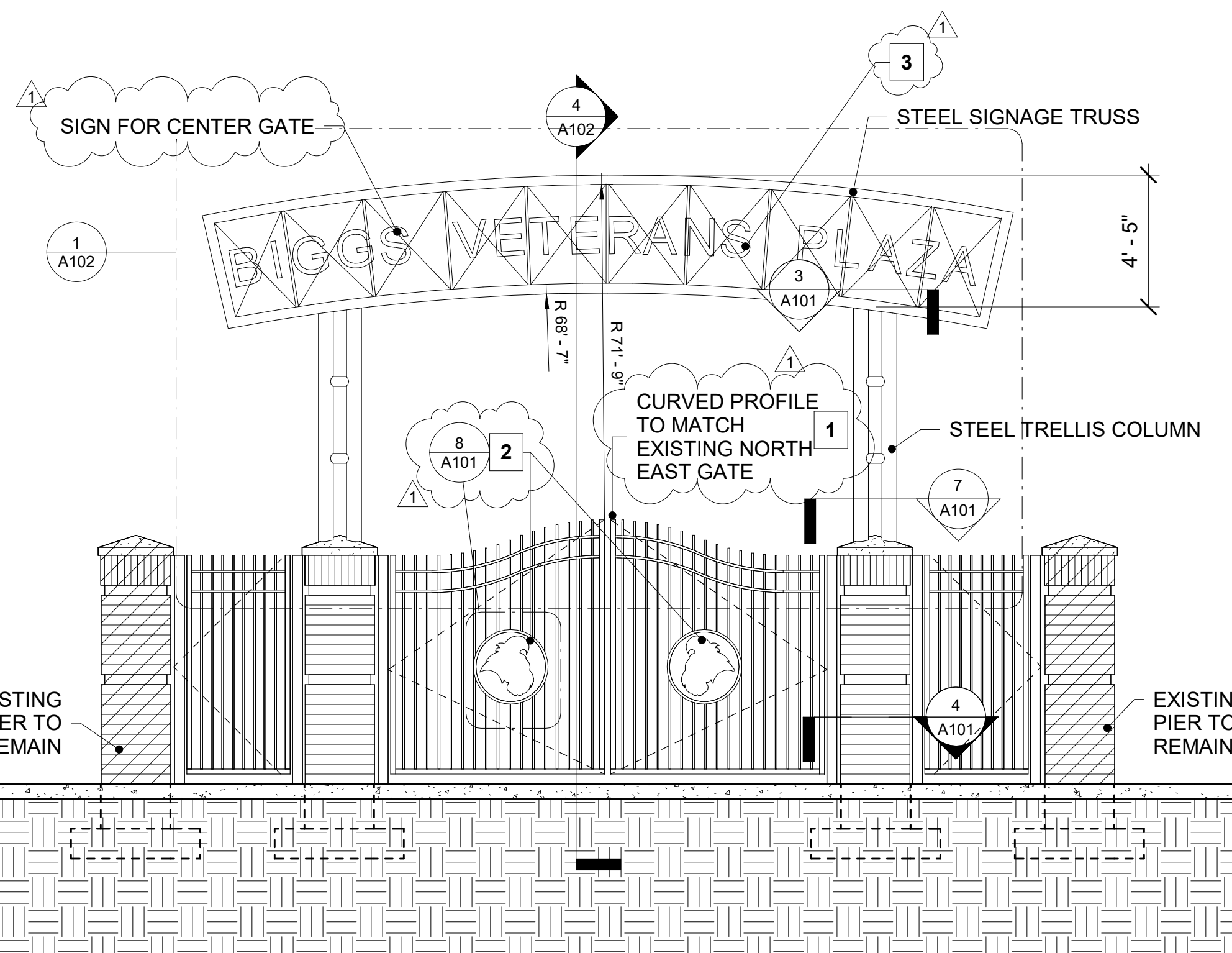

3 CENTER GATE 3 ELEVATION
1/4" = 1'-0"

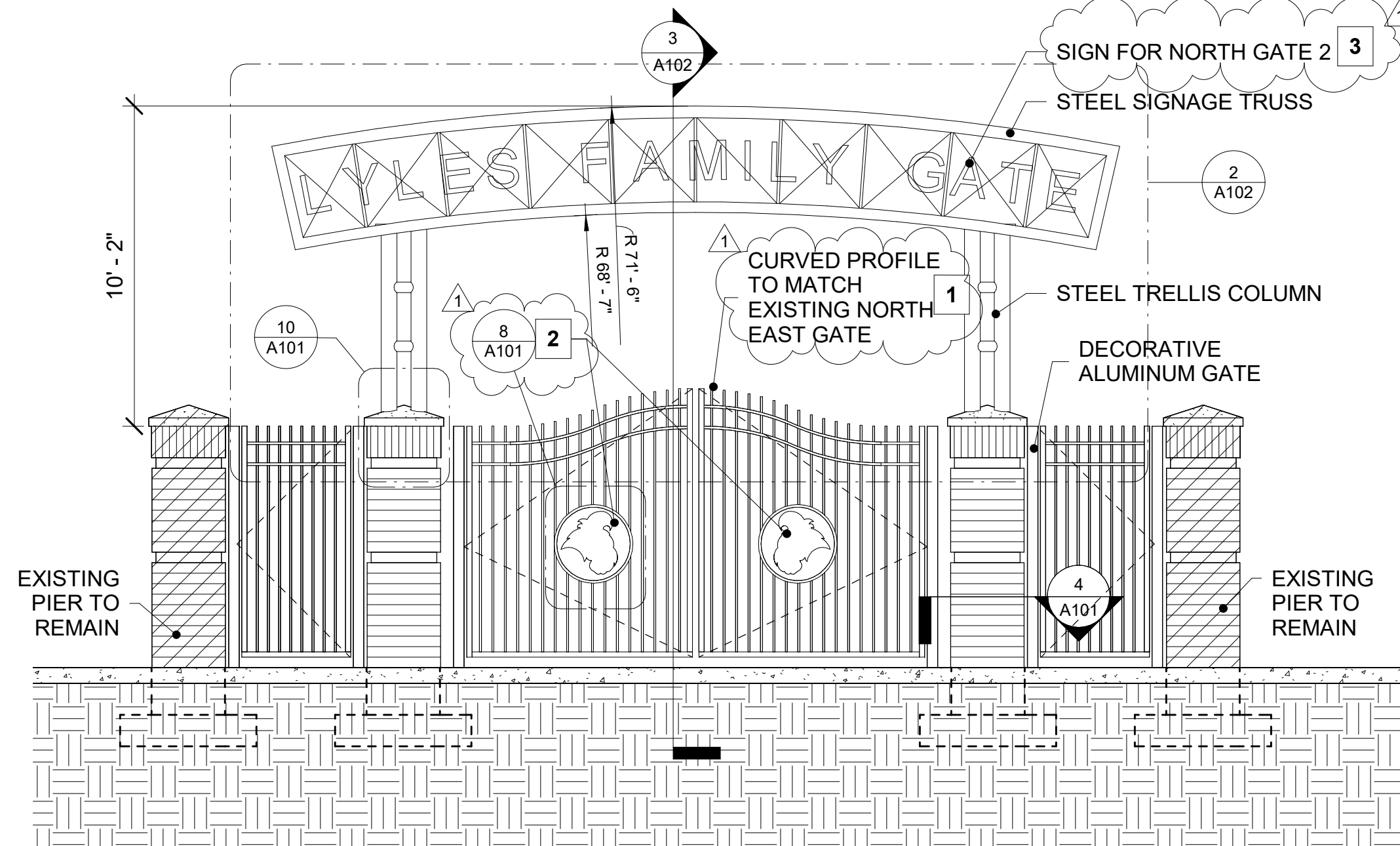

2 SOUTH GATE 4 AND NORTH GATE 2
ELEVATION
1/4" = 1'-0"

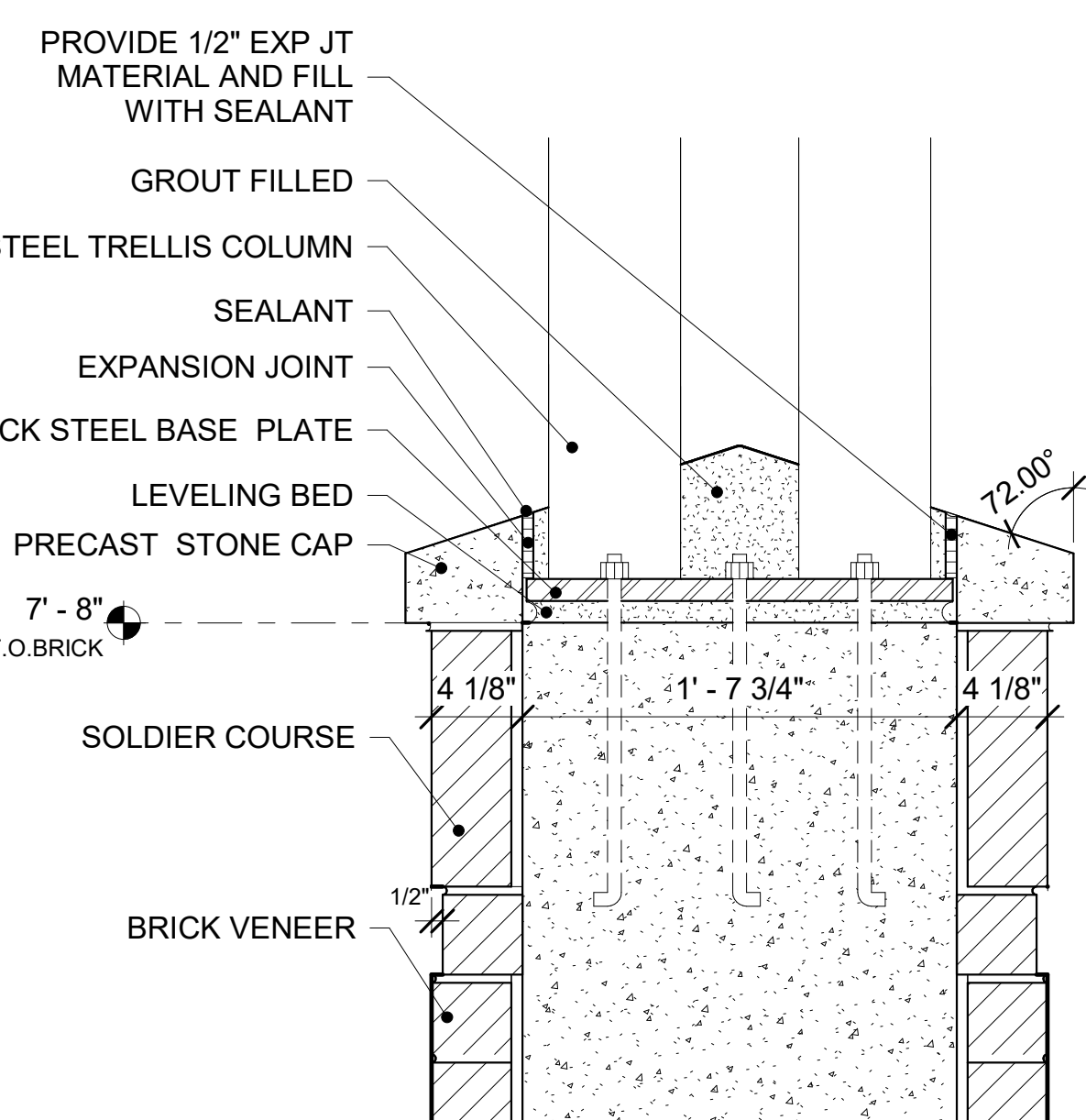

5 SECTION DETAIL @ GATE PIER/TRELLIS
1 1/2" = 1'-0"

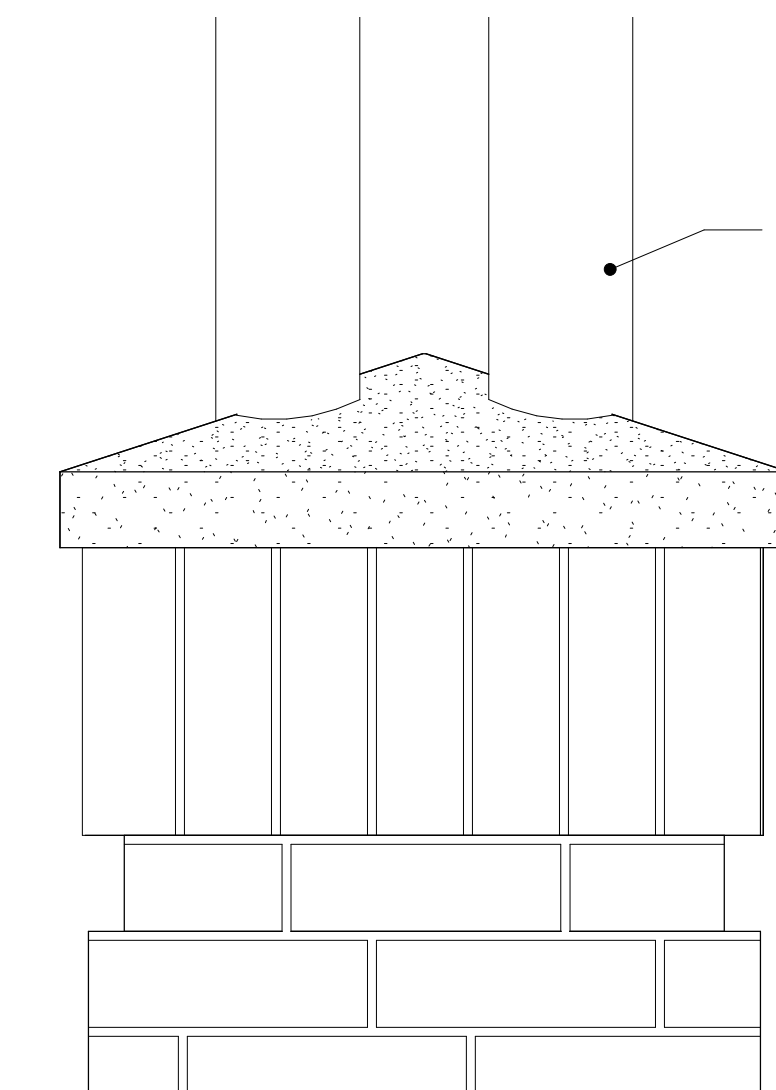

10 PARTIAL ELEVATION @ GATE PIER/
TRELLIS COLUMN
1 1/2" = 1'-0"

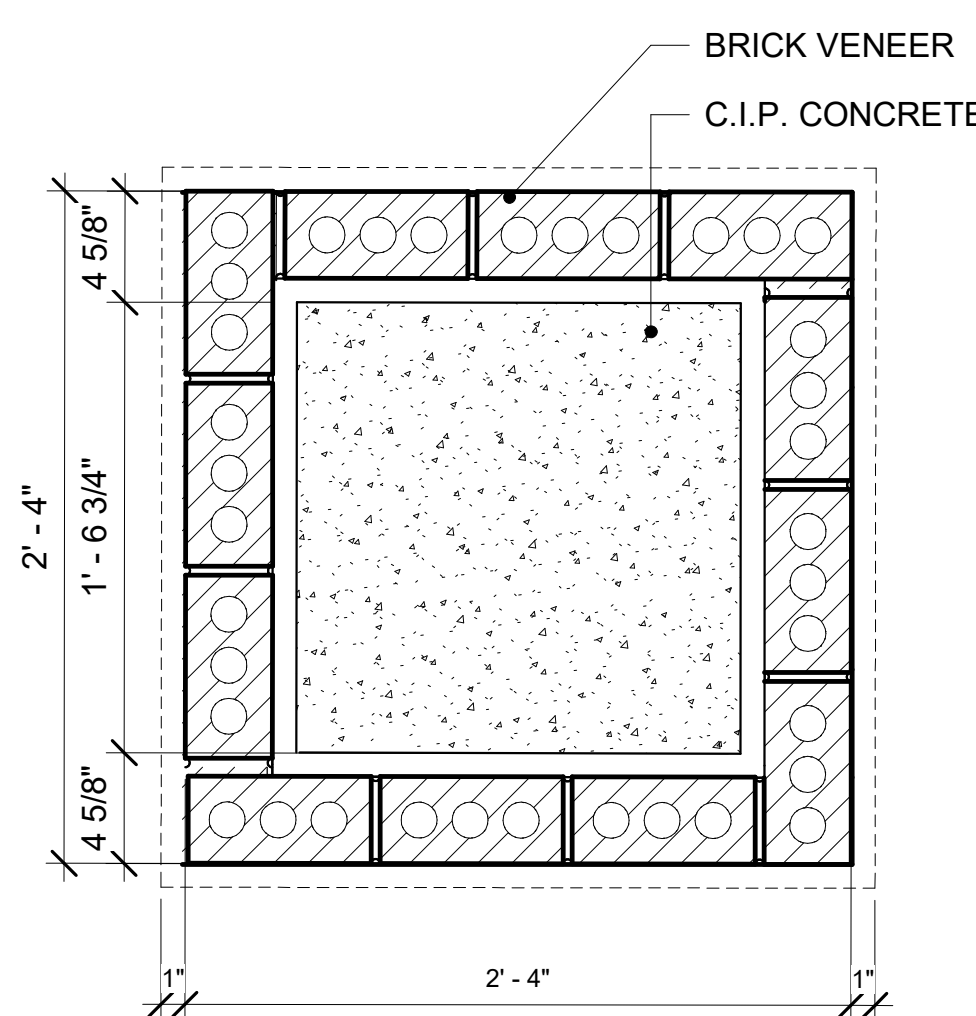

4 PLAN DETAIL AT GATE PIER
1 1/2" = 1'-0"

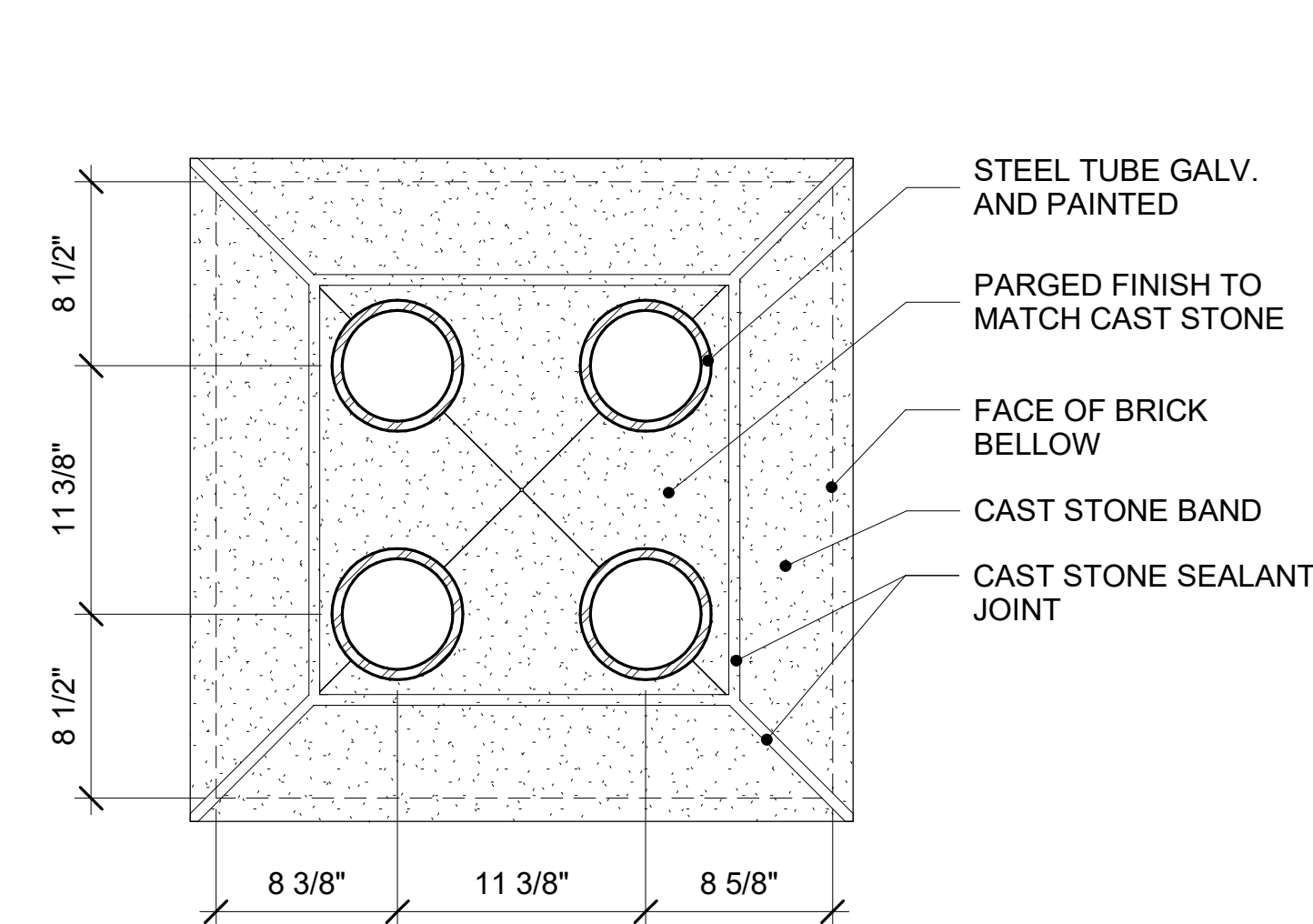

7 PLAN DETAIL AT GATE PIER/TRELLIS
COLUMN
1 1/2" = 1'-0"

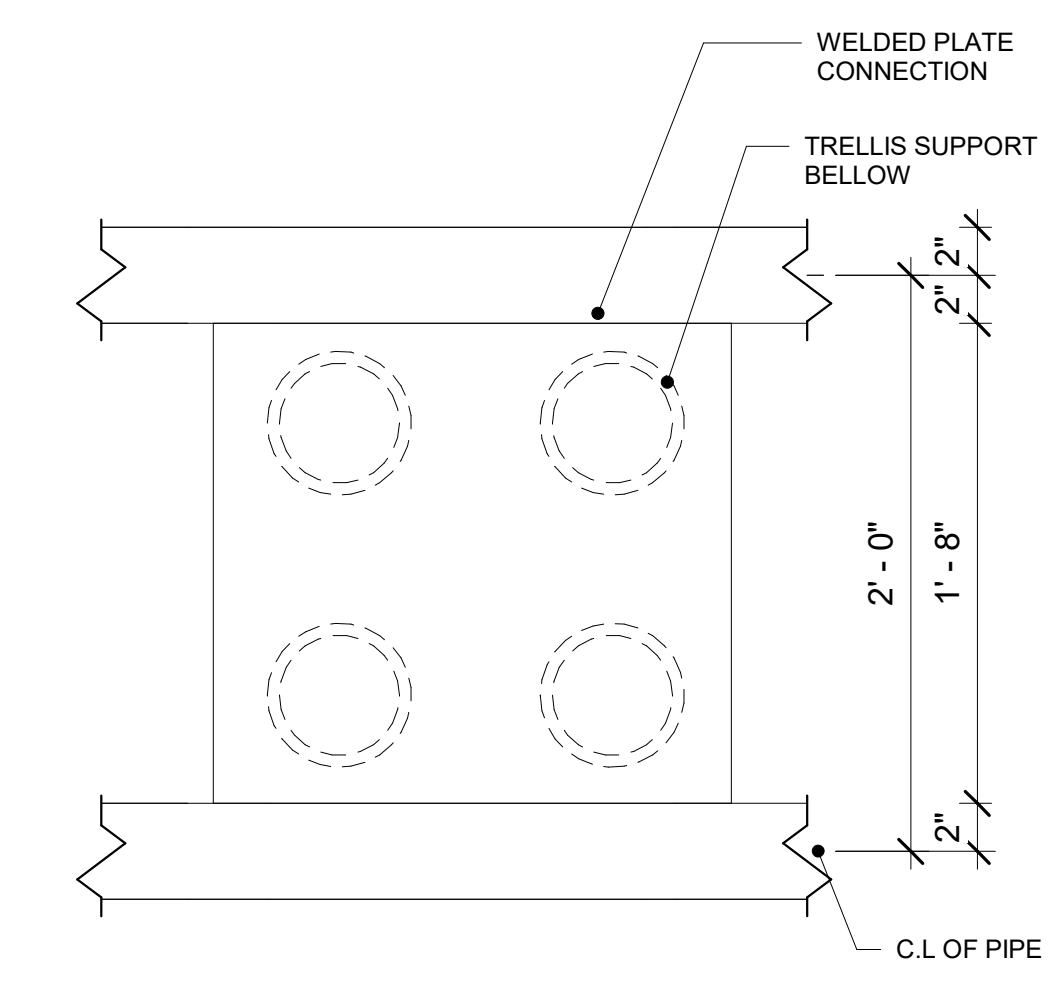

3 SECTION DETAIL AT GATE PIER/TRELLIS
1 1/2" = 1'-0"

project number **1905.00**

**CCU BROOKS
STADIUM EAST
GATES**

CONWAY, SC

**STATE PROJECT NO.
H17-N123-MJ**

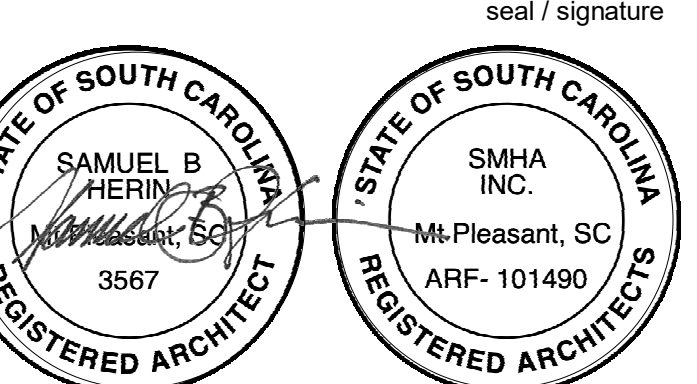

phase _____ date of issue _____

CONSTRUCTION DOCUMENTS 02.20.20

rev no.	description	revisions	date
1	ADDEMDUM 01		11.03.20

**PLANS, ELEVATIONS AND
DETAILS**

sheet number

A101

drawn by: _____ print date: _____

DRAWINGS MAY NOT BE REPRODUCED WITHOUT PERMISSION

ALL RIGHTS RESERVED

MEMBERS AMERICAN INSTITUTE OF ARCHITECTS

400 HIBBEN STREET MOUNT PLEASANT SOUTH CAROLINA

SMHA, Inc.

COPYRIGHT 2019

GENERAL NOTES:

- A. DIMENSIONS TO FACE OF MASONRY UNLESS NOTED OTHERWISE.
- B. ALL EXTERIOR MASONRY DIMENSIONS ARE NOMINAL. FOR ACTUAL DIMENSIONS SEE ENLARGED DETAILS. CONTRACTOR SHALL MAKE PROPER ALLOWANCES FOR JOINT DIMENSIONS WHEN LAYING OUT THE WORK.
- C. GENERAL CONTRACTOR TO LAYOUT LOCATION OF PIERS ACCORDING TO THE DIMENSIONS SHOWN ON THIS SHEET RELATIVE TO THE EXISTING PIERS.
- D. PATCH AND REPAIR ALL EXISTING CONSTRUCTION WHERE DEMOLITION OF ADJOINING OR INTERSECTING WORK RESULTED IN LESS THAN A FINISHED CONDITION. PATCHES SHALL BE FLUSH AND SMOOTH AND OF THE SAME MATERIAL AS EXISTING CONSTRUCTION.
- E. EXISTING WORK THAT ARE NOT INDICATED TO BE AFFECTED BY THE WORK ARE TO BE PROTECTED FROM DAMAGE. SHOULD THE GENERAL CONTRACTOR AFFECT THE CONDITION OR FINISH OF EXISTING WORK, THE SURFACE OR SPACE SHALL BE RESTORED TO ORIGINAL CONDITION.
- F. THE ELEVATION OF THE NEW PIERS SHALL MATCH THAT OF THE EXISTING PIERS.
- G. NOTIFY THE ARCHITECT OF ANY AND ALL DISCREPANCIES BETWEEN EXISTING CONDITIONS AND THE CONTRACT DOCUMENTS BEFORE PROCEEDING WITH THAT PORTION OF THE WORK. FAILURE TO NOTIFY THE ARCHITECT WILL NOT RELIEVE THE CONTRACTOR OF THE RESPONSIBILITY TO PERFORM THE WORK AS INTENDED BY THE CONTRACT DOCUMENTS.
- H. VERIFY EXISTING DIMENSIONS, CONDITIONS AND CLEARANCES PRIOR TO THE SUBMISSION OF SHOP DRAWINGS.

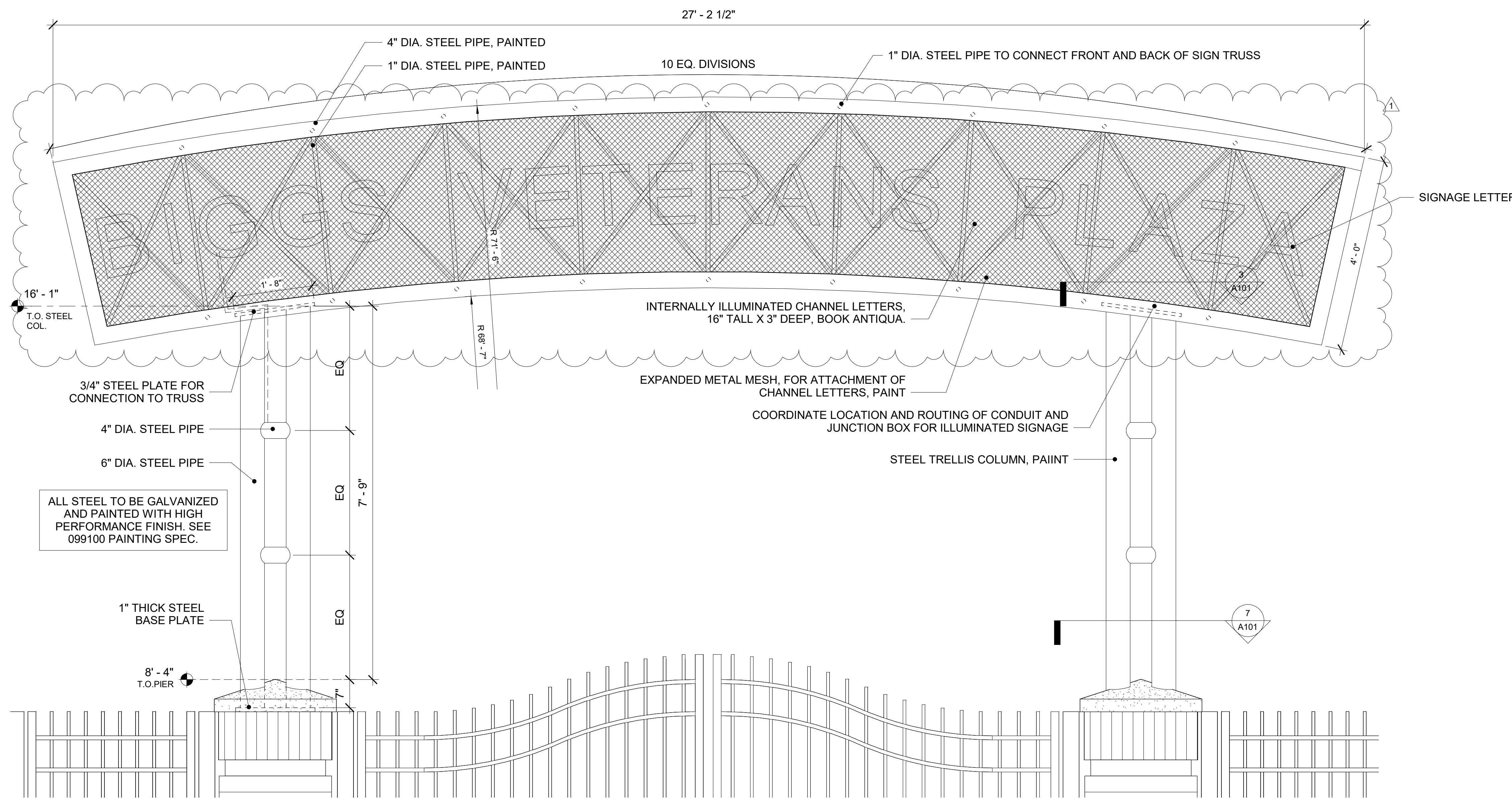

1 EAST CENTER GATE SIGN TRUSS
ELEVATION
3/4" = 1'-0"

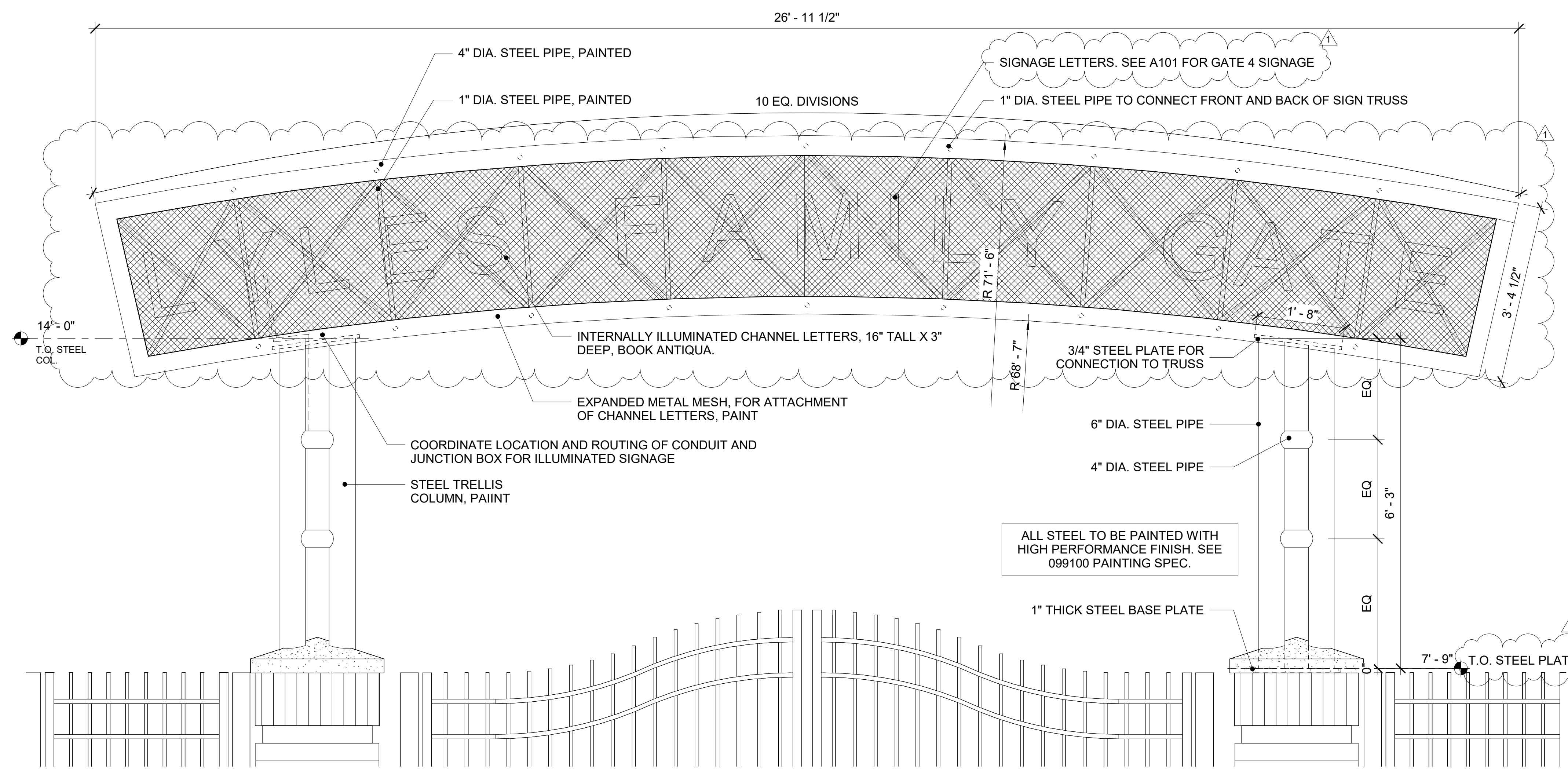

2 EAST SIDE GATE 2 SIGN TRUSS
ELEVATION (GATE 4 SIMILAR)
3/4" = 1'-0"

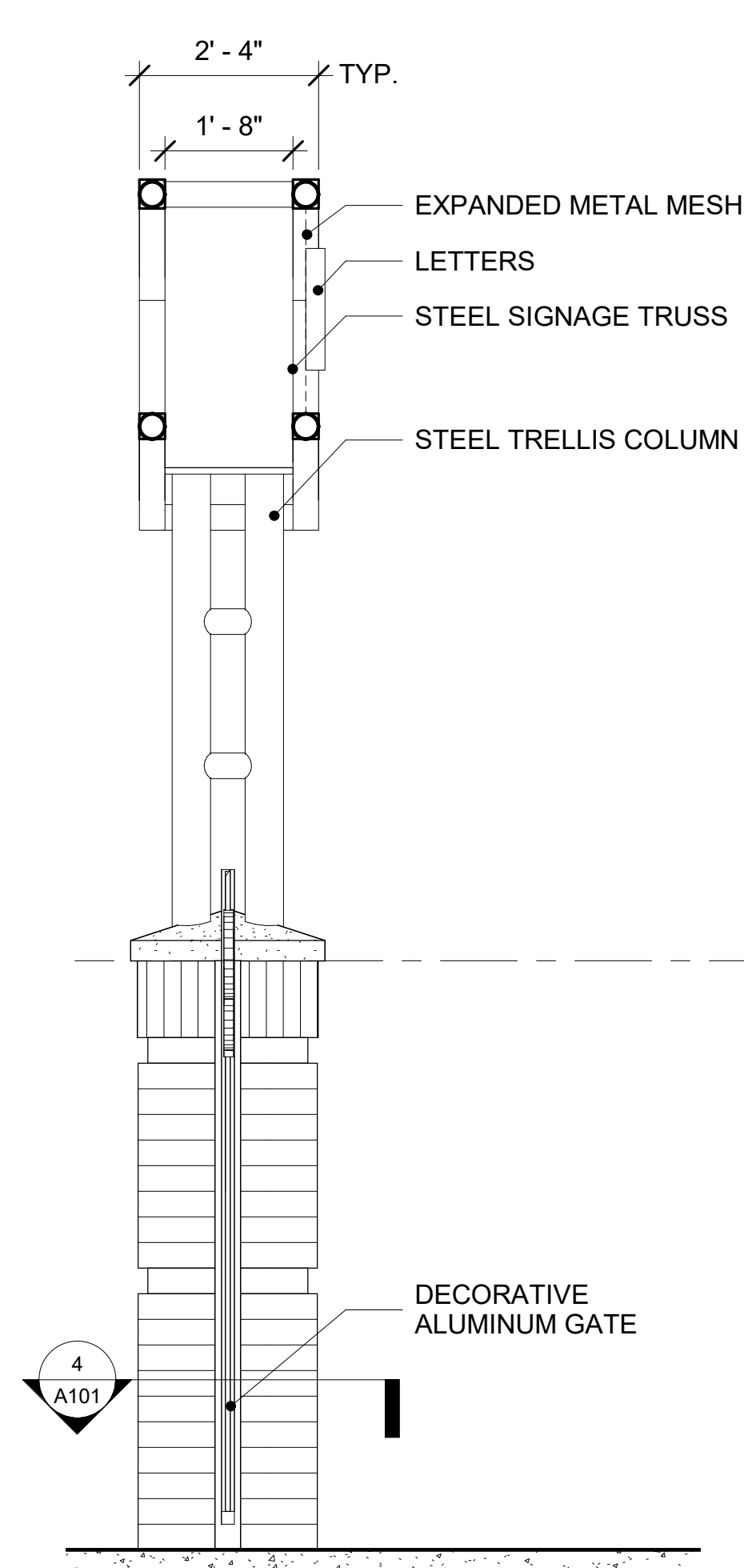

3 SECTION THROUGH SIDE GATE
1/2" = 1'-0"

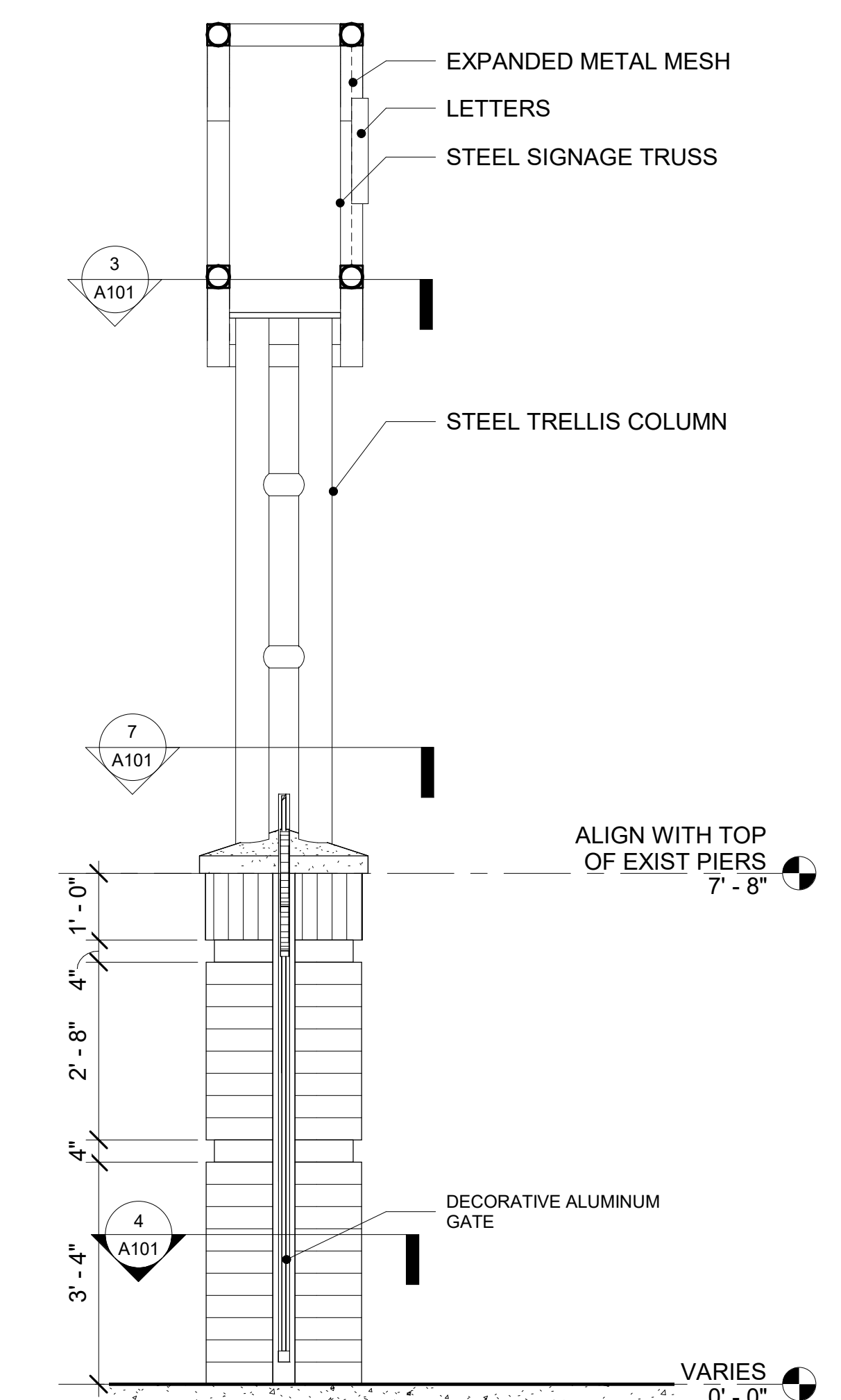

4 SECTION THROUGH CENTER GATE
1/2" = 1'-0"

DRAWINGS MAY NOT BE REPRODUCED WITHOUT PERMISSION. ALL RIGHTS RESERVED. MEMBERS AMERICAN INSTITUTE OF ARCHITECTS. 400 HIBBEN STREET MOUNT PLEASANT SOUTH CAROLINA. SMHA, INC. COPYRIGHT 2019

project number **1905.00**

CCU BROOKS STADIUM EAST GATES

CONWAY, SC

STATE PROJECT NO. **H17-N123-MJ**

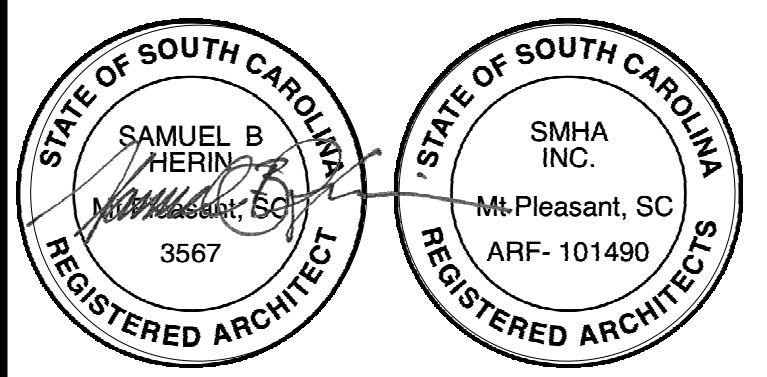

phase _____ date of issue _____
CONSTRUCTION DOCUMENTS **02.20.20**

rev no.	description	revisions date
1	ADDEMDUM 01	11.03.20

key plan sheet title
DETAILS

sheet number
A102

drawn by: _____ print date: _____

SPECIFICATIONS

SECTION 013000 - SUBMITTALS

1. PROVIDE PRODUCT DATA AND SHOP DRAWINGS TO GUIDE THE FIELD INSTALLATION OF ALL SYSTEMS. THE CONTRACTOR AND HIS SUBCONTRACTORS SHALL NOT USE THE CONTRACT DOCUMENTS AS SHOP AND COORDINATION DRAWINGS.

SECTION 14000 – QUALITY REQUIREMENTS

1. INFORMATION PERTINENT TO THE SCOPE OF WORK MAY OCCUR IN OTHER PORTIONS OF THE CONTRACT DOCUMENTS. REFER TO STRUCTURAL AND ELECTRICAL FOR ADDITIONAL NOTES. ALL NOTES ARE TO BE REVIEWED AND APPLIED TO RELATED BUILDING COMPONENTS.

2. THE STRUCTURAL AND ELECTRICAL DRAWINGS SUPPORT THE ARCHITECTURAL DRAWINGS IN DEFINING THE SCOPE OF WORK OF THE CONTRACT DOCUMENTS. DISCREPANCY BETWEEN THE ARCHITECTURAL AND THE ENGINEERING DRAWINGS SHALL BE BROUGHT TO THE ATTENTION OF THE ARCHITECT BEFORE COMMENCING WITH THE WORK. ANY WORK INSTALLED IN CONFLICT WITH THE ARCHITECTURAL DRAWINGS SHALL BE CORRECTED BY THE CONTRACTOR AT HIS EXPENSE AND AT NO ADDITIONAL COST TO THE OWNER.

3. DO NOT SCALE THE DRAWINGS. THE DRAWINGS ARE NOT NECESSARILY TO SCALE. THE CONTRACTOR SHALL VERIFY ALL CONDITIONS AND DIMENSIONS AT THE SITE PRIOR TO THE START OF CONSTRUCTION. IF DISCREPANCIES ARE FOUND, THE ARCHITECT SHALL BE NOTIFIED FOR CLARIFICATION BEFORE COMMENCING WITH THE WORK.

4. THE CONTRACTOR SHALL VISIT THE SITE AND BE KNOWLEDGEABLE OF CONDITIONS THEREON. HE SHALL INVESTIGATE, VERIFY, AND BE FAMILIAR WITH CONDITIONS OF THE PROJECT. HE SHALL NOTIFY THE OWNER OF ANY CONDITIONS REQUIRING MODIFICATION BEFORE PROCEEDING WITH THE WORK.

5. DETAILS NOT SHOWN ARE SIMILAR IN CHARACTER TO THOSE SHOWN. WHERE SPECIFIC DIMENSIONS, DETAILS OR DESIGN INTENT CANNOT BE DETERMINED, CONSULT THE ARCHITECT BEFORE PROCEEDING WITH THE WORK.

SECTION 016000 – PRODUCTS

1. DELIVER, STORE, AND HANDLE PRODUCTS USING MEANS AND METHODS THAT WILL PREVENT DAMAGE, DETERIORATION, AND LOSS, INCLUDING THEFT. COMPLY WITH MANUFACTURER'S WRITTEN INSTRUCTIONS.

2. MANUFACTURER'S DISCLAIMERS AND LIMITATIONS ON PRODUCT WARRANTIES DO NOT RELIEVE CONTRACTOR OF OBLIGATIONS UNDER REQUIREMENTS OF THE CONTRACT DOCUMENTS.

3. GENERAL PRODUCT REQUIREMENTS: PROVIDE PRODUCTS THAT COMPLY WITH THE CONTRACT DOCUMENTS, THAT ARE UNDAMAGED AND, UNLESS OTHERWISE INDICATED, THAT ARE NEW AT TIME OF INSTALLATION. PROVIDE PRODUCTS COMPLETE WITH ACCESSORIES, TRIM, FINISH, FASTENERS, AND OTHER ITEMS NEEDED FOR A COMPLETE INSTALLATION AND INDICATED USE AND EFFECT

SECTION 017000 – EXECUTION

1. SHORE, BRACE, AND SUPPORT STRUCTURAL ELEMENTS DURING CUTTING AND PATCHING. DO NOT CUT AND PATCH STRUCTURAL ELEMENTS IN A MANNER THAT COULD CHANGE THEIR LOAD-CARRYING CAPACITY. DO NOT CUT AND PATCH CONSTRUCTION IN A MANNER THAT RESULTS IN VISUAL EVIDENCE OF CUTTING AND PATCHING. REMOVE AND REPLACE CONSTRUCTION THAT HAS BEEN CUT AND PATCHED IN A VISUALLY UNSATISFACTORY MANNER.

2. CLEAN PROJECT SITE AND WORK AREAS DAILY, INCLUDING COMMON AREAS.

3. PROVIDE PROTECTION OF SITE AND WORK. MAINTAIN CONDITIONS THAT ENSURE INSTALLED WORK IS WITHOUT DAMAGE OR DETERIORATION AND CLEAN AT TIME OF SUBSTANTIAL COMPLETION

SECTION 024000 – DEMOLITION

1. COMPLY WITH GOVERNING EPA OR DHEC NOTIFICATION REGULATIONS BEFORE BEGINNING SELECTIVE DEMOLITION. COMPLY WITH HAULING AND DISPOSAL REGULATIONS OF AUTHORITIES HAVING JURISDICTION. COMPLY WITH ANSI/ASSE A10.6 AND NFPA 241.

SECTION 033000 – CONCRETE

1. SEE SHEET S105.

SECTION 042000 – MASONRY

1. SEE SHEET S105 FOR ADDITIONAL REQUIREMENTS.

2. TYPICAL BRICK: CAMPUS STANDARD "FORTERRA COLUMBIA 4 #605 WAVERLY MILLS" BY MERIDIAN BRICK (89 TO 92 MM).

4. COLORED CEMENT PRODUCT: PACKAGED BLEND MADE FROM MORTAR CEMENT AND MORTAR PIGMENTS, ALL COMPLYING WITH SPECIFIED REQUIREMENTS, AND CONTAINING NO OTHER INGREDIENTS. FORMULATE CUSTOM BLEND TO MATCH EXISTING.

SECTION 047200 - CAST STONE

1. CAST STONE UNITS COMPLYING WITH ASTM C 1364 USING EITHER THE VIBRANT DRY TAMP OR WET-CAST METHOD.

SECTION 055000 – METAL FABRICATIONS

1. SEE SHEET S105 FOR ADDITIONAL REQUIREMENTS.

2. MESH – EXPANDED METAL MESH IN FLAT BAR FRAME TO MATCH EXISTING NE GATE AND WEST STANDS TRELLIS. PAINTED.

3. COORDINATE INSTALLATION OF ANCHORAGES FOR METAL FABRICATIONS.

4. PREASSEMBLE ITEMS IN THE SHOP TO GREATEST EXTENT POSSIBLE. DISASSEMBLE UNITS ONLY AS NECESSARY FOR SHIPPING AND HANDLING LIMITATIONS. CUT, DRILL, AND PUNCH METALS CLEANLY AND ACCURATELY. REMOVE BURRS AND EASE EDGES TO A RADIUS OF APPROXIMATELY 1/32 INCH, UNLESS OTHERWISE INDICATED. REMOVE SHARP OR ROUGH AREAS ON EXPOSED SURFACES.

5. SHOP PRIME STEEL FABRICATIONS.

6. IMMEDIATELY AFTER ERECTION, CLEAN FIELD WELDS, BOLTED CONNECTIONS, AND ABRADED AREAS. PAINT UNCOATED AND ABRADED AREAS WITH THE SAME MATERIAL AS USED FOR SHOP PAINTING TO COMPLY WITH SSPC-PA 1 FOR TOUCHING UP SHOP-PAINTED SURFACES.

SECTION 099100 - PAINTING

1. PAINT, GENERAL

A. PRIMER: EPOXY, ANTI-CORROSIVE METAL PRIMER: MPI #101, BASIS-OF-DESIGN PRODUCT: S-W DURAPLATE 235 MULTI-PURPOSE EPOXY, B67W235.

B. INTERMEDIATE PAINT: FAST-CURE EPOXY COATING: MPI #108, BASIS-OF-DESIGN PRODUCT: S-W MACROPOXY 646, B58W6 SERIES.

C. TOP COAT: POLYURETHANE, TWO-COMPONENT, PIGMENTED, GLOSS: MPI #72, BASIS-OF-DESIGN PRODUCT: S-W HI-SOLIDS POLYURETHANE COATING.

2. STEEL SUBSTRATES (HIGH PERFORMANCE COATING): INCLUDING EXTERIOR STRUCTURAL STEEL COMPONENTS.

A. STEEL SHOP PRIMED.

B. SHOP-APPLIED EPOXY-COMPATIBLE PRIME COAT: KEM-KROMIK UNIVERSAL METAL PRIMER (APPLIED IN SHOP BY QUALIFIED APPLICATOR).

C. TREATMENT OF FIELD WELDS: CLEAN WELDS IN ACCORDANCE WITH SSPC-SP 3, "POWER TOOL CLEANING" AND SPOT PRIME WITH MULTI-PURPOSE EPOXY PRIMER.

D. SOLVENT WIPE: SOLVENT WIPE EPOXY PRIMER IN FIELD PRIOR TO APPLICATION OF TOPCOAT IN ACCORDANCE WITH SSPC SP-1. SOLVENT WIPE FIELD INSTALLED BOLTS AND SPOT PRIME WITH MULTI-PURPOSE EPOXY PRIMER.

E. INTERMEDIATE COAT: FAST CURE EPOXY (FIELD APPLY TO ALL BOLTS AND WELDS).

G. TOPCOAT: POLYURETHANE, TWO-COMPONENT, PIGMENTED, GLOSS (TO BE FIELD APPLIED BY QUALIFIED APPLICATOR WITHIN 90 DAYS OF EPOXY PRIMER APPLICATION).

SECTION 101400 - SIGNAGE

1. FABRICATED CHANNEL CHARACTERS: METAL FACE AND SIDE RETURNS, FORMED FREE FROM WARP AND DISTORTION; WITH UNIFORM FACES, SHARP CORNERS, AND PRECISELY FORMED LINES AND PROFILES; INTERNALLY BRACED FOR STABILITY, TO MEET STRUCTURAL PERFORMANCE LOADING WITHOUT OIL-CANNING OR OTHER SURFACE DEFORMATION, AND FOR SECURING FASTENERS.

2. FONT AND SIZE AS INDICATED ON DRAWINGS TO MATCH EXISTING.

3. ILLUMINATED CHARACTERS: FRONTLIGHTED CHARACTER CONSTRUCTION WITH LED LIGHTING, INCLUDING TRANSFORMERS, INSULATORS, AND OTHER ACCESSORIES FOR OPERABILITY, WITH PROVISION FOR SERVICING AND CONCEALING CONNECTIONS TO BUILDING ELECTRICAL SYSTEM. USE TIGHT OR SEALED JOINT CONSTRUCTION TO PREVENT UNINTENTIONAL LIGHT LEAKAGE. SPACE LAMPS APART FROM EACH OTHER AND AWAY FROM CHARACTER SURFACES AS NEEDED TO ILLUMINATE EVENLY.

4. FINISHES: ALUMINUM SHEET ASTM B 209 AND EXTRUSIONS ASTM B 221. POWDER COAT TO MATCH EXISTING. ACRYLIC SHEET: ASTM D 4802 TO MATCH EXISTING.

SECTION 323000 - FENCING

1. INSTALLER CONWAY FENCE CO. OR EXPERIENCED INSTALLER WHO HAS COMPLETED ORNAMENTAL FENCES AND GATES SIMILAR IN MATERIAL, DESIGN, AND EXTENT TO THOSE INDICATED FOR THIS PROJECT AND WHOSE WORK HAS RESULTED IN CONSTRUCTION WITH A RECORD OF SUCCESSFUL IN-SERVICE PERFORMANCE.

2. MANUF. BARRETTE OR EQUAL DECORATIVE ALUMINUM FENCE AND GATES TO MATCH EXISTING. 1 INCH PICKETS AT 6 INCHES O.C. WITH FINIALS TO MATCH EXISTING. 1-1/2 INCH HORIZONTAL RAILS. 2-1/2 INCH X 2-1/2 INCH MINIMUM WELDED GATE FRAME. CCU ATHLETIC TEAM LOGO AS INDICATED ON DETAIL.

project number **1905.00**

CCU BROOKS STADIUM EAST GATES

CONWAY, SC

STATE PROJECT NO. H17-N123-MJ

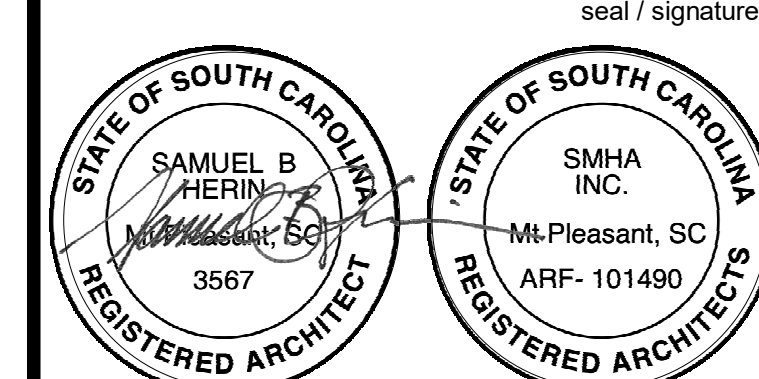

phase _____ date of issue _____

CONSTRUCTION DOCUMENTS 02.20.20

rev no.	description	date
1	ADDEMDUM 01	11.03.20

key plan
sheet title

SPECS

sheet number

A103

drawn by: _____ print date: _____